

WHERE THE FRAILS  
CROSS

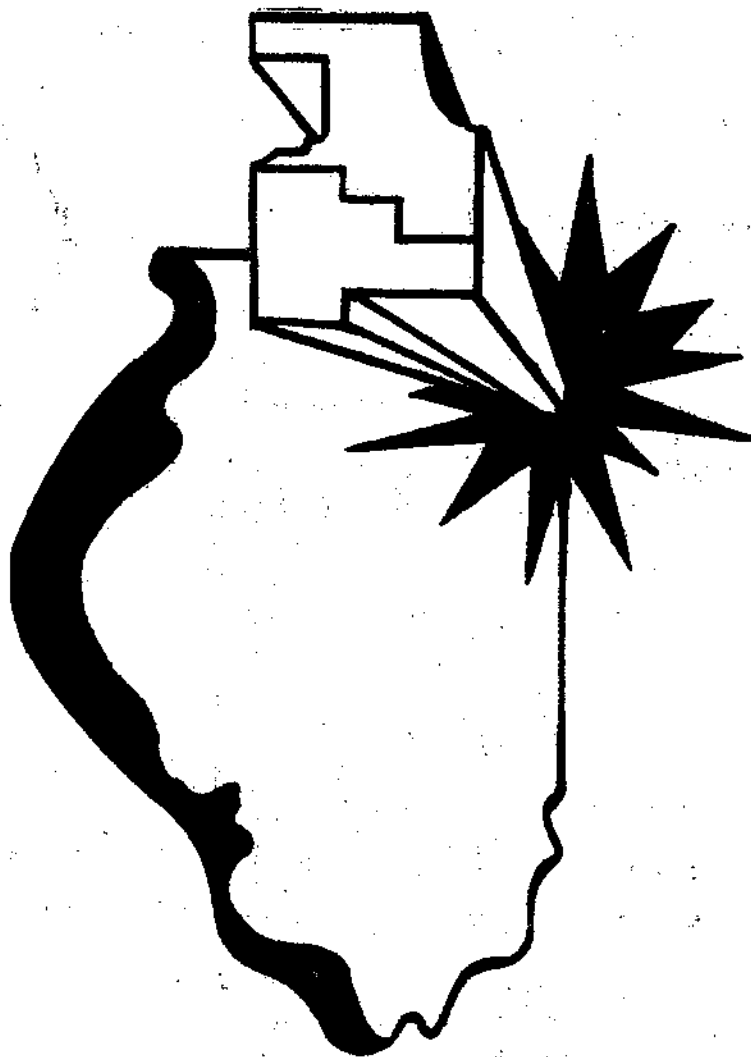

SOUTH SUBURBAN GENEALOGICAL AND HISTORICAL SOCIETY  
P.O. BOX 96 SOUTH HOLLAND, ILL. 60473

Vol. 7, No. 1, Fall 1976

FEATURING BREMEN TOWNSHIP

## Featuring BREMEN TOWNSHIP

"A large crowd of strangers, as it were, had met here for adventure."  
Thomas Ford, early governor of Illinois, THE HEARTLAND, p. 14, TIME-LIFE  
Library of America, 1967.

**THE BOUNDARIES** Take a leisurely drive northward from 183d Street along Harlem Avenue, through Tinley Park to 135th Street, and turn east, passing through Crestwood and Robbins. Then work your way south through Posen, Markham and Hazel Crest to 183d Street, and then go west through Country Club Hills, back to your starting point at 183d and Harlem. These are the boundaries of Bremen Township, one of the prettiest parts of South Cook County. Don't miss the lovely views along Central Avenue, which will take you through Oak Forest, and take a turn to the east on 147th Street, which will lead you through the village of Midlothian.

**EARLY SETTLEMENTS** Enough rolling countryside and woodland remain here to help us visualize the paradise found by the first white settlers. The large groves of virgin timber gave rise to such names as "Coopers Grove" (named for the legendary Mr. COOPER, said to have been the first white resident of the township, in the early 1830's) and Bachelors Grove. Coopers Grove included parts of the present villages of Oak Forest and Country Club Hills and the St. Michael Forest Preserve. The Coopers Grove-area was also called "Yankee Settlement" at one time. Bachelors Grove, on the north-west corner of the township, is said to have derived its name from the large number of unmarried men who were original settlers.

**YANKEES, GERMANS and IRISH** After the Indians were forced to cede title to the land (Treaty of 1832) white settlers came to turn Indian hunting grounds into fertile fields. The first immigrants were from New England's worn out farms, and then fugitives from famine in Ireland and from political upheaval in Germany swelled the numbers. It was the German settlers who called the area "New Bremen", in memory of their port of debarkation.

**VILLAGES GROW UP** The post office at Coopers Grove was first called New Bremen, and finally Oak Forest. Tinley Park was called "New Bremen" until it was incorporated in 1892. Midlothian grew from a stop the Rock Island "milk train" made at Rexford Crossing--to serve the farmers whose homes bordered the narrow lane which became 147th Street. The name Midlothian was first applied to a golf club established by wealthy Chicagoans--now Midlothian Country Club. In the late 1800's there was a tiny village named Goesselville at 147th and Oak Park, named for George C. GOESEL. The post office existed from 1884 to 1903.

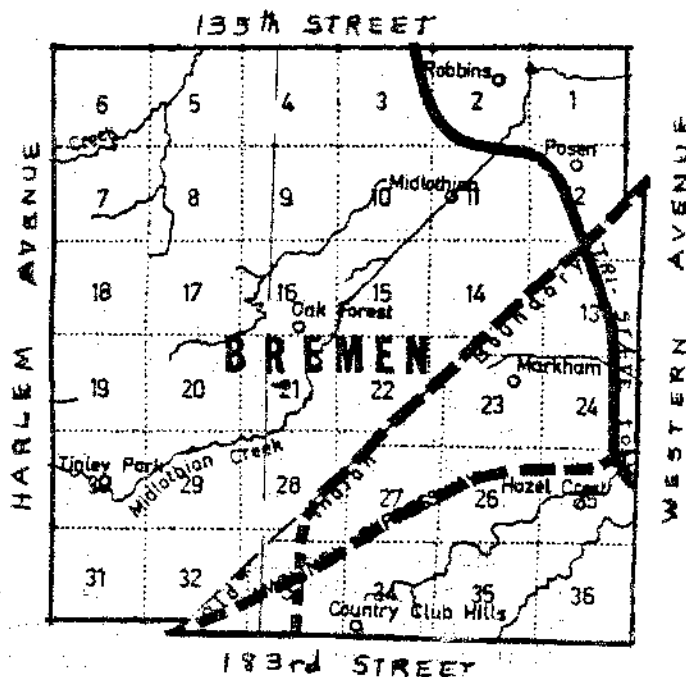

TYPICAL SETTLERS John FULTON and Jane JOHNSON, both born in Ireland in 1813, married in Ireland and came to the United States in 1839. In 1844 they came to Bremen Township and purchased 80 acres of woodland in the Bachelors Grove settlement. Here they reared a family of 14 children. John FULTON increased his holdings until at the time of his death (1883) he owned more than 1000 acres. Jane FULTON died in 1897 and both were buried in Bachelors Grove Cemetery.

Benjamin COOL and his wife Jane, both born in New York state, came to Bremen Township in the 1840s and settled on a farm where the Midlothian Country Club now stands. In the 1850s COOL built a stone house at 148th and Cicero whose outside walls were two feet thick. This house was owned by members of the COOL family until 1918, and it remained standing until 1972, when it was destroyed by fire. This house served as the area's first courthouse. The farm stretched along Cicero from 147th Street to 159th Street.

The SCHIAEDEKES, brothers Wilhelm and Diedrich, came to the U.S. from Hanover in 1840, settling first in DuPage County. In 1850 they purchased land in Bremen Township between Crawford and Cicero along 159th Street (north of Oak Forest Hospital). Diedrich married Catherina MAGIUS, also from Hanover. They raised a family of eight children. One of their sons, Ernst, married Anna SEBRAGE, and remained on the family farm. Ernst SCHIAEDEKE's tombstone in St. John's (Lutheran) Cemetery bears these dates: b. 29 Nov 1857, d. 3 Dec 1924. The farm was in possession of the SCHIAEDEKE family until it was purchased by the Cook County Forest Preserve District in 1924 (now Midlothian Meadows.)

Christ and Johanna ABBE left their native Darmstadt and came to what is now Oak Forest in 1850, having spent thirteen weeks on a sailing vessel. They took the train from New York to Blue Island and walked from there to Oak Forest. Christ worked as a farm hand, earning 25¢ a day, and eventually bought a farm between 152nd and 155th streets and west of Cicero Avenue. William ABBE, one of the nine children, had a farm east of Cicero at 155th Street. (There are several ABBE tombstones in Trinity Evangelical Lutheran Cemetery in Tinley Park.)

CHURCHES and SCHOOLS The earliest religious services were held by the Methodists about 1843. The first meetings were in the home of Frank and Mary MINARD, who had come from New York State.

The first non-parochial school in the Bremen Settlement was taught by Daniel O. ROBINSON in 1852. This school must have been conducted in private homes as no school building was built until 1863.

The large influx of German immigrants in the 1840s and 1850s made Lutheranism the predominant religion in the township. St. John's Lutheran Church was organized in Coopers Grove in 1849, and church, school and parsonage were housed in one building. A lovely stone building, erected in 1874, is still in use. (Although many families of Bremen Township were among the parishioners of St. John's, the property lies in Rich Township. A history of the church, complete with a membership list from 1849--1934 appears in Where The Trails Cross, Vol. 3:2, which featured Rich Township.)

Some of the original landowners of Bremen Township whose surnames appear on St. John's membership were: HENKE, HOECKMAN, VOGT, WERFELMAN, HUPE and PATHE.

## TRINITY EVANGELICAL LUTHERAN CHURCH

Trinity Lutheran Church has a history of the longest continuous congregation in Bremen Township. It was established in 1859 by the Rev. Wolfgang Simon STUBNATZY, pastor of St. John's Lutheran Church of Coopers Grove, to serve the German settlers of Petzel's Grove or Berzel's Grove or Bachelor's Grove, as the area was variously described. A two-story building was erected on land obtained from Friedrich ENGELHARDT, a building which served as parsonage, school and place of worship. A modern church and school on 159th St. between Oak Park and Harlem Avenues is near the site of the original building.

In 1861 the congregation called the Rev. Herman WUNDERLICH to be its first pastor. Rev. WUNDERLICH also served as the teacher of the school, and he served as pastor and teacher for ten years.

In 1871 the Rev. J. H. C. MARTIN became the pastor, and remained for a term of thirteen years. It was during this time that fire razed the building--it burned on Christmas Day in 1883. The building was replaced by the beautiful structure pictured here, constructed in 1884 by Christian and Henry GOPFSEL.

Pastor Theodors BUENGER succeeded the Rev. MARTIN in 1884. In 1890 the

congregation incorporated, and in 1893 became a member of the Missouri Synod. Pastor BUENGER tried conducting services in English but this innovation was not accepted until 1935, and even after that sermons were given in both languages for many years. (The Rev. BEUSCHLEIN, present pastor of Trinity, commented that there were times when the congregation was ready for English services, but influxes of German immigrants after both World Wars made it necessary to continue services in the German language.)

The 1884 building was in continuous use until 1963 when it was replaced by the present sanctuary. Not too long after its replacement the historic old building was destroyed by fire.

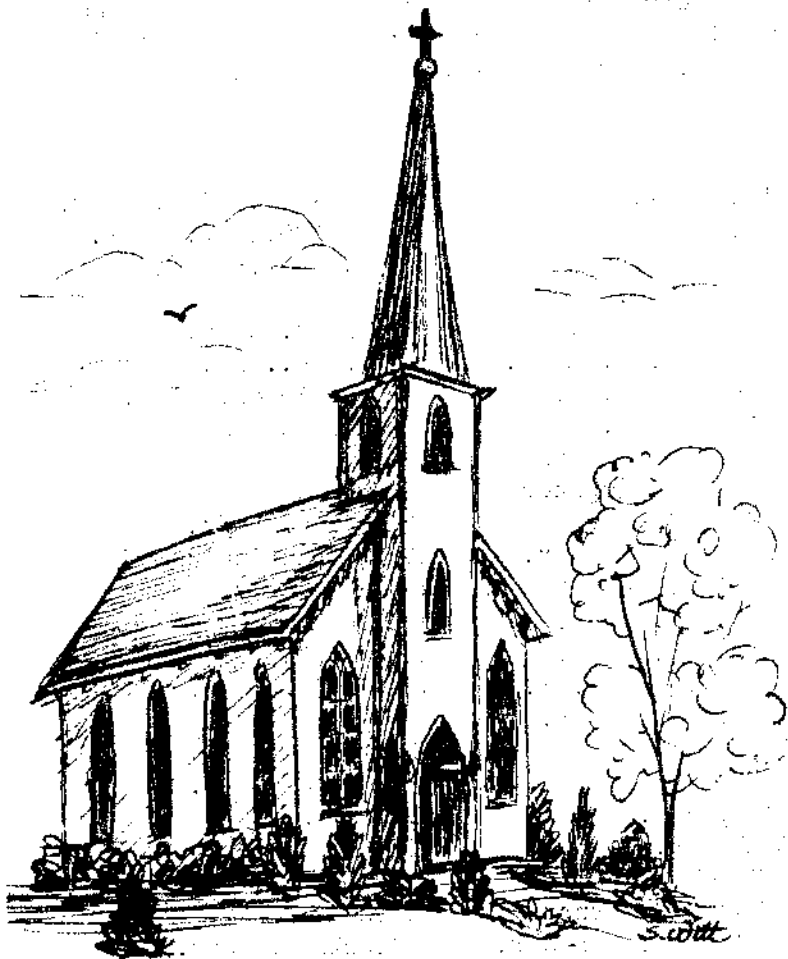

CHARTER MEMBERS

Christian ABBE, Sr.	Lorenz GAUS	Justin KNIERIEM
Lorenz BURKHARDT	John HUHNSTOCK, Sr.	Karl REICHERT
Peter DEHNHARDT	Philip HUHNSTOCK	John SCHALLER
Friedrich ENGELHARDT	Friedrich KIMMEL	Christian SCHILLING
		George WEBER

MINISTERS 1859--1976

Wolfgang S. STUBNATZY	1859-1861	Martin FRICK	1935-1940
Herman WUNDERLICH	1861-1871	Fred PFOTENHAUER	1940-1943
J. H. C. MARTIN	1871-1884	Oswald WOELZLEIN	1943-1948
Theodore BUENGER	1884-1891	David MENSING	1948-1951
Walter KREBS	1891-1917	Carl HOEH	1952-1963
Wm. GREVE	1917-1935	A. F. C. PFOTENHAUER	1964-1970
	Carl W. BEUSCHLEIN	1970-	

Editors' Note: We were privileged to copy material from Trinity Evangelical Lutheran Church Record, 16 May 1860--31 Dec 1889. The following lists of early communicants, marriages, and baptisms were extracted from its pages. In the original record, communicants were listed by settlements: Sand Ridge, Blue Island, Berzels Grove (Bachelors Grove), Worth, Worth Ostern and Black Oak.

COMMUNICANTS, 1860-1866

ABBE, Chr. & fr.	BOLTE, H. I.	ENGELHARDT, With. & fr.
ABBE, Fr. & fr.	BOLTE, W.	ENGELHARDT, Wm. & fr.
ABBE, Henr.	BOLTE, W. I.	ENGLAND, P. & fr.
ABBE, Henriette	BORMET, Phil. & fr.	
ABBE, Louis	BREITBARTH, Chr.	FINN, Fr. & fr.
ABBE, Louisa	BREITBARTH, H. & fr.	FINN, Fr., Jr.
	BREITBARTH, J. G. & fr.	FRITZ, Joach. & fr.
BANG, Henriette	BREITERD, Joh.	FUCHS, Julius
BANG, Wm.	BREITERT, Christina & daughter	GANTZ, Caroline
BARTELS, Georg. & fr.	BREITERT, Peter	GANTZ, L. & fr.
BARTHEL, Heindr. & fr.	BRINKHOFF, H. & fr.	GANTZ, Rufina
BAUER, Ad. & fr.	BRODERIUS, Joh. & fr.	GOERING, Caroline
BAUER, Soph.	BUNSEN, Wm. & fr.	GOERING, Chr. & fr.
BAUMGARTEN, Anna E.	BUNSEN, Wm. & fr.	GORING, Aug.
BAUMGARTEN, Elizab.	BURKHARD, Georg. F.	GRAU, Fr. & fr.
BAUMGARTEN, F.M. & fr. & sohn	BUSETT, Carl & fr.	
BAUMGARTEN, Phil	BUSH, Carl	HARDER, Wittwe
BENZ, Peter & fr.		HARM, Fr. & fr.
BLESH, Georg. & fr.	EHLERS, Joh. & fr.	HARM, H. & fr.
BØEHM, Cathar.	EINSPAR, P. & fr.	HEIDEN, Carl & fr.
BOEHM, Chr. & fr.	EISENBRANDT, Chr.	HENNEBERG, Emilie
BOEHM, Chr. & fr.	EISENBRANDT, Ernst	HENNEBERG, Fr. & fr.
BOEHM, Elis.	EISENBRANDT, Eva Chr.	HENNEBERG, Henr.
BOEHM, Fr. & fr.	ENGELHARDT, Carl	HENNIMANN, -- & fr.
BOEHM, Fr., Jr.	ENGELHARDT, Fr. & fr.	HERWIG, Joh. & fr.
BOEHM, Jacob & fr.	ENGELHARDT, Louis	HERWIG, Mrs.
BOLTE, H. & fr.	ENGELHARDT, Louisa	HERWIGHT, Theo.

HILGENDORF, Fr. & fr.  
 HILGENDORF, H. & fr.  
 HILL, George & fr.  
 HOEHN, Elis.  
 HOFFELD, Joh. & fr.  
 Horst, W. & fr.  
 HOSTMANN, Carl & fr.  
 HUHNSTOCK, Christiana  
 HUHNSTOCK, F. G. & fr.  
 HUHNSTOCK, Fredericka  
 HUHNSTOCK, G. H. & fr.  
 HUHNSTOCK, Louis  
 HUHNSTOCK, M. C.  
 HUHNSTOCK, Wittwe

JAEDECKE, Carl  
 JORN, E.

KAMIN, Joh.  
 KAMIN, Wittwe  
 KLOTZ, Fr'd'ka  
 KOHLER, Cath.  
 KOHLER, Fr. & fr.  
 KOTT, E. & fr.  
 KOTT, George & fr.  
 KOTT, Wm. & fr.  
 KRAEGER, Carl & fr.  
 KREBY, Chr. & fr.  
 KREBY, George  
 KROGER, Carl  
 KRUGER, Joh. & fr.  
 KUECH, Anna  
 KUECH, Mary  
 KUHRING, Carl

LADAWASSER, Chr. & fr.  
 LANG, Fr. & fr.  
 LANGE, Fr. & fr.  
 LANGE, Joh. & fr.  
 LANZ, F. G. & fr.  
 LOSS, Joh. & fr.

MAGER, Jac. & fr.  
 MANKE, Chr. & fr.  
 MARTENS, H. & fr.  
 MAYER, Jacob  
 MEYER, M. & fr.  
 MILLIES, Joh. & fr.  
 MOHR, Bernh. & fr.  
 MOHR, T. & fr.  
 MOHR, J. & fr.  
 MOHR, Joh. & fr.

MOLLER, Heinr. & fr.  
 MOLLER, Hen. & fr.  
 MOLLER, Wm. & fr.  
 MUELLER, Aug. & fr.  
 MUELLER, Mrs.  
 MULLER, Aug.  
 MULLER, H. & fr.

PETERSON, H.  
 PFEIL, Geo. & fr.  
 PFEIL, H. & fr.  
 PREIL, Joh--  
 PORN, Fr. & fr.  
 PORMO, Joh. & fr.

QUAST, Fr.

RAMOSSA, Mrs.  
 RAUCH, Anna  
 RAUCH, Mary  
 REICHERT, G.  
 REIFERT, Fran.  
 REIFERT, Gottfr.  
 ROHLER, Fr. & fr.  
 ROSSOW, Joh. & fr.  
 RUECKLE, G.--  
 RUST, Aug. & fr.

SANGER, Joach. & fr.  
 SAUERBIER, Chr. & fr.  
 SAUERBIER, Chr., Jr.  
 SAUERBIER, Fr.  
 SAUERBIER, Fr., Jr.  
 SAUERBIER, Fritz  
 SAUERBIER, George  
 SAUERBIER, Loui  
 SAUERBIER, W.  
 SCHEIN, Martin & fr.  
 SCHILLHASE, Andr. & fr.  
 SCHILLING, Chr. & fr.  
 SCHILLING, Christel & fr.  
 SCHILLING, D. & fr.  
 SCHILLING, David & fr.  
 SCHILLING, Mrs.  
 SCHMIDT, Chr. & fr.  
 SCHMIDT, Ferdi & fr.  
 SCHMIDT, Franz & fr.  
 SCHNEKEL, Joach. & fr.  
 SCHNURSTEIN, Carl & fr.  
 SCHONSTEDT, Chr. & fr.  
 SCHROEDER, G.  
 SCHULTZ, Dor.

SCHULTZ, Henr. & fr.  
 SCHWEDLER, Joh. & fr.  
 SCHWER, With.  
 SEIFERT, Joh. & fr.  
 SIPPEN, Carol.  
 SPECHT, Mrs.  
 SPEKEN, Ernstine  
 SPRINGMAN, Curl & fr.  
 STRUNG, Fr. & fr.  
 STEINMETZ, G. & fr.  
 STORZ, Aug.  
 STORZ, Augusta  
 STOZ, F. G. & fr.  
 STORZ, G. & fr.  
 STORZ, J. G. & fr.  
 STRUCK, Fr. & fr.  
 STUBNATZY, W. L.

TELLNER, Joh & fr.  
 TOPFER, Henr. & fr.

VOGT, Carl & fr.

WACHSMUTH, H. & fr.  
 WACHSMUTH, H. I.  
 WACHSMUTH, Mor.  
 WADEL, Henr.  
 WADSWORTH, H. C. & fr.  
 WAGENRAD, Chr.  
 WAGENRAD, M.  
 WAGENRAD, Mrs.  
 WAGENRAD, W.  
 WAGENRAD, Wittwe  
 WEBER, H.  
 WEBER, Heinr.  
 WEBER, Jacob & fr.  
 WEBER, Joh.  
 WEBER, Marg.  
 WEIGAND, M.  
 WEISE, Fried.  
 WEISE, Gottl. & fr.  
 WUNDERLICH, C.  
 WUNDERLICH, Cath.  
 WUNDERLICH, C. M.  
 WUNDERLICH, C. M., Mrs.  
 WUNDERLICH, G. & fr.  
 WUNDERLICH, H.  
 WUNDERLICH, Julius & fr.  
 WUNDERLICH, Sal.  
 WUNDERLICH, Sara

MARRIAGES 1861-1880

<u>Bridegroom</u>	<u>Bride</u>	<u>Marriage Date</u>
ABBE, Fried.	HUHNSTOCK, Johanna	9 June 1861
ABBE, Johann F.	BORMET, Catherina	16 May 1880
ALBRECHT, Herm.	KLITZING, Wilhelmina	9 June 1862
ANDERSON, Hans	HEINKMULLER, Franken	20 Dec 1864
BAUMGARTEN, Phillip	GOERING, Carolina	9 May 1869
BECK, W. Edward	KOHLER, Anna C.	20 Nov 1876
BORMET, Christian	SCHILLING, Bertha W. H.	12 Dec 1880
BORMET, Phillip	SCHICK, Wilhelmina	8 Dec 1878
BORNHAUSEN, Carl W.	SOLLNER, Juliane	24 Sept 1876
BRANDT, Luis	WITT, Maria	-- July 1870
BREITBARTH, Karl	NIELSEN, Maria E. C.	26 Mar 1879
DOERRE, August	STORZ, Auguste E.	27 Nov 1870
DREISCHERF, Louis H.	SAUERBIER, Maria C.	2 Jan 1880
EHLERS, Jochim C.	KRUGER, Caroline (born LUDKE)	21 Dec 1874
ENGELHARD, Carl	GROSSKOPF, Johanna	7 July 1866
ENGELHARD, Geo. F.	WUNDERLICH, Sara	12 Dec 1867
ENGELHARD, W.	ROMMOSA, C.	9 May 1861
ENGELHARDT, Johann H. E.	SOHNHOLZ, Sophia M. D.	20 Apr 1875
FENNER, Ferdinand	MULLER, Albertine	8 Jan 1870
FROHLICH, Heinrich	BAUMGART, Johanna C.	19 May 1874
GLOGOWATZ, Thomas	ERNST, Cath.	24 Oct 1866
GOEBEL, Johann	ABBE, Henriette	26 Dec 1867
GORING, August Edw.	SCHILLING, Henriette C. M.	18 Apr 1873
GOSENVISCH, Friedrich	SCHROEDER, Friedericke	10 Mar 1878
GROSSKOPF, Carl F. A.	STORZ, Mina F.	16 May 1875
GROSSKOPF, Christoph	PINO, Fried'ka	10 Apr 1870
GROSSKOPF, H.	KELLMER, Julia	16 June 1861
GROSSKOPF, Louis	SACHMANN, Josephine M.	14 Apr 1874
GROSSWURTH, Heinrich P.	HENKE, Louise S. C.	22 Jan 1879
HAASE, Friedrich	NIEMANN, Caroline	22 Feb 1878
HALZ, Fried.	IMME, Maria	26 Mar 1868
HARTMANN, Gottfr.	GOERING, H.	13 Jan 1861
HEISE, August	MOLLER, Elisabeth	7 Apr 1872
HORN, Justus	KUCH, Elisabeth (born KOTT)	14 Mar 1878
HOSTMANN, Carl	PAUL, Sophia	26 Oct 1862
HUHNSTOCK, Loui	FRANK, Fried'ka	23 Apr 1871
HUHNSTOCK, Wilhelm	ABBE, Louisa	28 May 1874
JACOB, Peter	ROSE, Katharina C.	1 Apr 1872
KAMIEN, Johann	BOKEL, Elisab.	14 Oct 1866
KAUTMANN, Joh.	KUTCHMANN, Maria	20 Nov 1867
KLEPPER, Johann	HACKER, Caroline	19 Dec 1873

KNIERIEM, Justus	FRIEDRICHS, Margaretha M.	28 Nov 1879
KOENLER, Heinrich	EAUMGARTEN, Anna Elis.	25 Apr 1869
KOHL, Anton	WIELAND, Elisabeth	20 Feb 1870
KROEGER, Carl	BOLDT, Carol.	2 Jan 1862
KUCH, Paulus	KOTT, Elisabeth	4 Mar 1872
LUETKE, Wilhelm	SCHMIDT, Henriette	26 Dec 1869
MAYHOFF, Heinrich	PEHLING, Elisabeth S. M.	29 Aug 1879
MEESKE, Carl	GORS, Fr.	11 Sept 1861
NEUMANN, Wilhelm F. A.	LUETKE, Karoline E.	30 May 1880
OETTERER, Johann F.	NAGEL, Caroline F. A.	8 Oct 1876
PECHT, Rudolf	VORKAUFER, Agnes	20 Dec 1863
QUAST, Friedrich	PETERSON, Friedericke	8 Feb 1863
RHEDE, Wilhelm	SCHWINNENDORF, Fr'ka	19 June 1868
ROSE, Carl F.	KRUEGER, Ernestine W.	6 May 1877
ROSE, Friedrich J. C.	SCHUDDT, Sophia J. C.	23 Jan 1880
RUST, Heinrich A. W.	STORZ, Emma L.	9 Nov 1879
SCHALLER, Joh.	SCHLEIB, Friedericke	19 May 1867
SCHICK, Joh. Cr.	KOENLER, Cath.	15 Jan 1871
SCHILLING, Christoph.	WITT, Marie	11 July 1878
SCHILLING, Chr. G.	KLOTZ, Soph.	13 Apr 1862
SCHILLING, Johann C.	BORMET, Elizabeth	20 June 1879
SCHMIDT, Aug.	BROMBECK, Anna	13 Jan 1861
SCHMIDT, Johann W.	KRUSPE, Christine W.	6 Feb 1876
SCHNEIDER, Albert W.	SCHEMAAL, Anna M.	15 Dec 1875
SCHNELL, Wm.	WALTER, Maria	27 Apr 1862
SCHNURSTEN, Joseph	HAGEDORN, Anna	2 July 1865
SCHROEDER, Joh.	SCHMIDT, Cath.	16 June 1861
SIEMSEN, Fettef (?)	HARDER, Emma	27 Dec 1874
SIEMSEN, Haasch	KOEPCHEN, Wme.	8 Mar 1867
SIEVERS, Wilhelm	LEESE, Marg.	10 Dec 1865
SIPPEL, Carl	MANK, Maria	25 Feb 1869
STOHR, Christoph. W.	KUCH, Anna Maria	14 Feb 1875
STORZ, Johann H. F.	HADENICHT, Wilhelmine C.	13 Apr 1879
UTHE, Conrad	KRUSPE, Johanna K. L.	20 July 1879
VOGT, Heinrich	WILLE, Mathilde	28 Aug 1874
VOLCK, Heinrich	WANNEMACHER, Katharine	17 June 1873
WACHSMUTH, Heinrich	STIEF, Martha C.	7 Jan 1872
WANNEMACHER, Johann	VOGEL, Louise V.	-- Feb 1875
WATERSTRAD, Julius	GEFAUER, Sophia	18 Nov 1866
WEBER, Heinrich	KLOTZ, Friedericke	13 May 1867
WEBER, Jacob	ENGELHARD, Louisa	17 Sept 1865
WEISSENBORN, Michael	DOBERENZ, Pauline	6 Dec 1874

WICK, Ch. H. REHBERG, M.  
 WOLF, Heinrich JUNKER, Magdalena  
 WUNDERLICH, Julius GANTZ, Rufina

11 Sept 1861<sup>m</sup>  
 9 Sept 1877  
 23 Dec 1863

BAPTISMAL RECORDS 1860--1861

<u>Child</u>	<u>Birth date</u> <u>Baptismal date</u>	<u>Parents</u>
ABBE, Martha Christiane	18 Oct 1859	ABBE, Christoph Johanne
APPEL, Wilhelm	16 May 1861	APPEL, Carl Augusta
BAUER, Georg. Chr. L. M.	23 June 1861	BAUER, G. Sophia
BECKER, Heinr. Carl Christoph	15 Oct 1860	BECKER, - - - - Maria
BELLOF, Elisabeth	31 May 1861	BELLOF, John Sophia
BINGER, Carl Fried.	22 June 1861	BINGER, Fr. Maria
BINGER, Cathar, Dorothea	6 Mar 1860	BINGER, Fr. Maria
BOEHNING, Ida Frd'ka Dorothea	8 July 1860	BOEHNING, W. Maria, nee STEINBACH
BREITBARTH, Johann Martin	6 July 1860	BREITBARTH, H. Louisa, nee HUHNSSTOCK
BRODERIUS, Heinr. Peter	3 Feb 1861	BRODERIUS, Joh. Elisab., nee HEID
BUEHLER, Fredericke Henriette Emilie	22 Aug 1858	BUEHLER, Phil. Henr., nee WEISE
DURKHARD, Johanne Elis. Wilhe.	3 Feb 1861	DURKHARD, Carl Lusida, nee KIMEL
BURKHART, Georg. Adolf	22 Aug 1860	BURKHART, H. BUPE, Joh.
BUPE, Albert	1 Apr 1861	BUPE, Joh. Marg., nee DIEKMANN
(RUPE?)	28 Apr 1861	ENGLAND, P. Marg., nee BUSCH
ENGLAND, Peter Heinr.	9 June 1861	ERBE, Jacob Salome, nee RINKERT
ERBE, Carolina Louisa	12 Mar 1861	ERBE, Jacob Salome, nee RINKERT
ERBE, August Conrad	24 May 1860	ERNST, Fr. Christiane
ERNST, Otto Fr. Peter	26 Aug 1860	FELZIER, E. C. T. Auguste
FELZIER, Ernst Chr. Fr.	9 Nov 1860	FRITZ, Joachim Dorothea, nee SIEBERT
FRITZ, Joachim Peter Carl	9 June 1861	
	15 July 1860	
	23 Sept 1861	
	20 Sept 1859	
	10 Nov 1861	

Continued on page 44

## A HISTORY OF THE VOGT FARMSTEAD, NOW ORCHARD HILL FARM

by  
Natalie Johnson

Henry VOGT, born 15 August 1815 in Germany, married Gertrude BURSCHENK, born 8 June 1814. In 1847 the couple immigrated to Cook County with two boys: Carl, born in 1839 and Edward, born 1843. After a few days in Chicago, the family established a home in Bremen Township, purchasing land in Section 28.

Edward VOGT continued living in the homestead after his father's death on 10 April 1854. The farm then was passed to his son, Fred, who married Hattie SAUL. After Fred's death, Hattie continued to live on the farm, which was still known as the Hattie VOGT farm when Les and Natalie JOHNSON purchased about 10 acres, including the buildings, in October 1943.

During extensive renovation and remodeling, the JOHNSONS found evidences of additions and changes in the house and the barn. The original 1847 house was a one story 20' by 30' frame structure of 12" x 12" beams over a 10' deep cellar, mortised together with wooden pegs. The cellar walls are of 18" Joliet limestone and the floor of 12" square tile with an imprinted design. The only way to the cellar was through a trap door on the southeast corner of the main floor. When plaster was taken from the ceiling, the 12" x 12" beams showed where the stove pipe had gone directly through wooden flooring and scorched the wooden beams.

The second floor of the original wing was unfinished, but the main frame had been sawed and spliced, literally raising the roof to make a 7½' ceiling. The Johnsons finished this large room which was the original Kindergarten, started in 1947, and is now a first grade room for the Orchard Hill Farm School.



A second 20' x 30' wing was added to the first one, apparently at the same time as the full 2nd floor was built. Hand-hewn or rough sawed beams, and square nails are used throughout both wings. A few of the original glass panes exist. The two wings form a "T" with a porch on both sides of the original wing.

The farm became a show place of the area with a flourishing apple, cherry and pear orchard on the North Hill. The outbuildings included the barn, a summer kitchen incorporating the "outhouse", a machine shed with a high ceiling and two sets of double doors, two hen houses and a long shed that could shelter many animals from the northwest wind.

A hand-dug, limestone-lined well was discovered at the bottom of the hill where old Cicero (now Kilpatrick) and 167th Streets meet. Because old records tell of a trading post in that area, the Johnsons theorize that the well marks the spot for the wagoners stopping-place. Indian Chief Basil WHITE EAGLE, a neighbor, re-inforces that theory, saying that Indians traveled that route, and that a well was a necessity for weary travelers.

Local residents have memories of the Hattie VOGT farm as a well-kept, happy place, with beautiful trees, garden and orchard. The black walnut, horse chestnut, ash and maple trees are still growing, with apple, cherry and pear trees planted more recently.

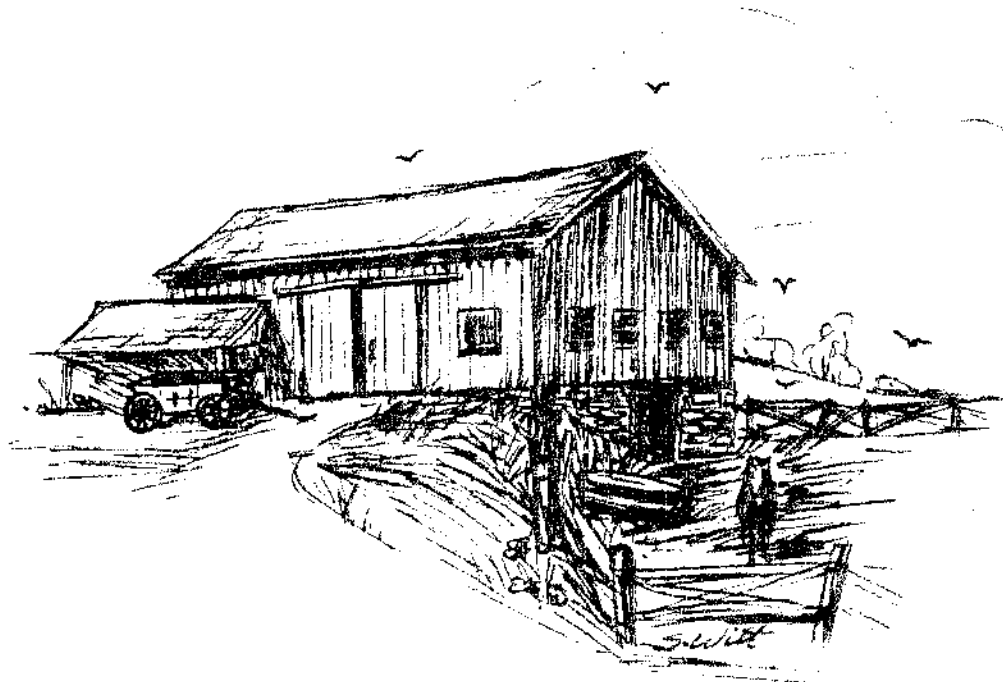

The barn structure shows that the original barn was built at about the same time as the house--same construction with beautiful beams and wooden pegs. The wide original floor is still there. The first part of the barn was 30' wide and 50' long, built on the hillside with double doors for hayracks at top-of-the-hill level, and doors, hay mows and cattle stanchions at the lower level. Horses were kept on the second level. A hay mow completed the barn. Later the barn was extended to 67' long, extending the horse facilities, storage rooms, work rooms, and the hay mow. Much of the barn is the original construction and all of the buildings have their original wood siding, still in good condition.

One of the former residents of the farm was Verna GROTH, Ruth BETTENHAUSEN'S sister. Mrs. GROTH brought photos of the farm from Colorado when she visited in the spring of 1975. She wrote "I sure would like to visit the farm again. It was a nice place to live. Is the big chestnut tree still north of the house? I always enjoyed that so much for its shade. Bernice GEE also has pictures of happy family gatherings on the farm, starting in 1917, ending with a Home Bureau picnic at the then Johnson farm in 1950.

Mrs. GROTH recorded some of her memories of the early 1900s. She remembered sitting on the north porch, facing the orchard and Oak Forest "Poor Farm". Sundays the patients would be treated to a band concert, sounds of which would waft up the hill one-half mile away if the north wind was blowing. But her most gruesome recollections concerned the "winos" who made their own alcohol and sometimes died as a result. The wagons going to the Potters Field could be seen and were heavily loaded during the World War I flu epidemic.

Marian FUNK SWISHER also remembers experiences and stories told about the farm. She tells the story of one funeral held in the farmhouse, (probably for Fred VOGT). Burial was on the hill near present-day Brennan Highway because of muddy roads. Years later the body was removed to the Lutheran Cemetery on 167th Street.

The original farm buildings have all been preserved, the grey house with white trim (now painted red with white trim), the barn, summer kitchen, carriage house and other outbuildings. The house has been the home of Les and Natalie JOHNSON and their five children for the past thirty three years. In 1946 Natalie started a Kindergarten for their daughter Merrilie in the farmstead. The school has grown to occupy the carriage house with two wings added and the summer kitchen--now "The Little Red School Library". A farm dinner bell now calls over 200 children at the start of each day. The barn holds hay, corn, two sheep, two ponies, and some ducks. Surrounding suburban children 3 thru 12 years of age ride buses to the farm where many children for 30 years have been exposed to traditional, as well as innovative learning, in a happy unique farm setting on the old Hattie VOGT farm, now known as Orchard Hill Farm. The old farm is still a "happy place."

\* \* \* \* \*

When D. & S. Witt visited the farm for pictures, this duck was their guide.

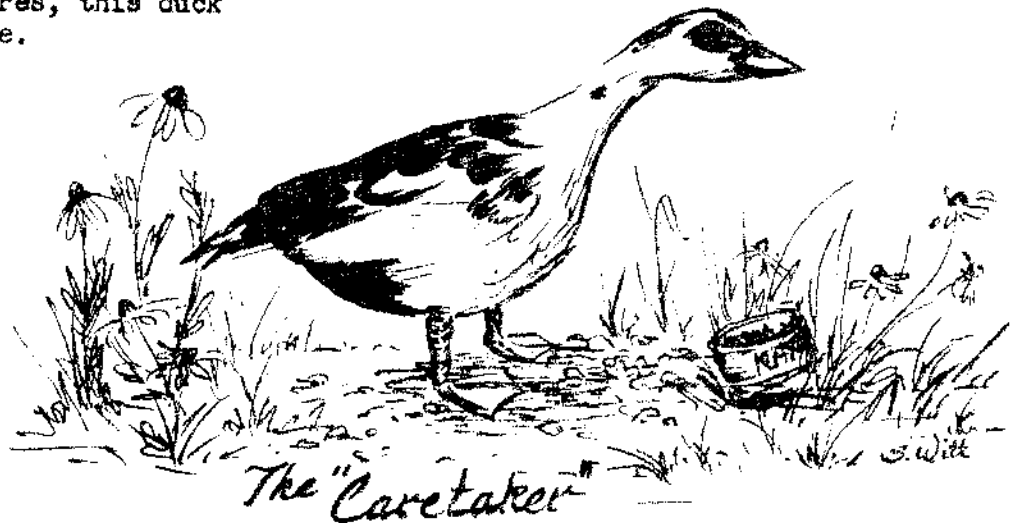

GOVERNMENT LAND OFFICE RECORDS

Bremen Township, Cook County, Illinois--T 36 N, R 13 E

<u>Purchaser</u>	<u>Descr.</u>	<u>Sec.</u>	<u>Acres</u>	<u>Price</u> \$	<u>Purchase</u> <u>Date</u>	<u>Receipt</u> <u>Number</u>	<u>Date of Patent</u> <u>and Patentee if</u> <u>Diff. fr. Purchaser</u>	<u>Recorded</u> <u>Vol.</u>	<u>Page</u>
Andrews, Dan L.	NW 1/4	29	160	200.	25 June 1835	2247	1 Oct 1839	8	427
Andrews, David	SE 1/4	17	160	200.	3 Oct 1836	4111	1 Oct 1839	5	154
Andrews, Joel	SW 1/4	20	160	200.	26 June 1835	2246	1 Oct 1839	8	457
Andrews, William	SW 1/4	17	160	200.	5 Oct 1836	4113	1 Oct 1839	8	468
"	NW 1/4	20	160	200.	3 Oct 1836	4119	1 Oct 1839	8	468
"	SW 1/4 NE 1/4 SW 1/4	28	158.37	197.95	25 July 1836	4046	1 Oct 1839	8	365
Barton, Rufus	W 1/2 SW 1/4	4	80	100.	26 June 1835	2287			
"	E 1/2 SW 1/4	5	80	100.	13 June 1835	198			
"	E 1/2 SE 1/4	6	80	100.	26 June 1835	2288			
"	E 1/2 NE 1/4	7	80	100.	" "	2289			
Bauch(?), Isaac H.	NE 1/4 SW 1/4	12	-	-	14 Nov 1849	28157			
Blackstone, John	SE 1/4	20	160	200.	7 Aug 1835	2279	1 Oct 1839	5	187
"	W 1/2 NE 1/4	20	80	100.	" "	2845	" "	6	235
"	E 1/2 NW 1/4	28	80	100.	" "	2280	" "	5	188
"	E 1/2 SE 1/4	29	80	100.	25 June 1835	2281	" "	5	189
"	W 1/2 NW 1/4	22	160	200.	" "	2278	" "	5	186
"	W 1/2 NE 1/4	28	80	100.	26 June "	2277	" "		
"	E 1/2 NE 1/4	29	80	100.	" "	2276	" "		
Blanchard, F. G.	E 1/2 E 1/4	4	320	400.	29 Oct 1836	4115	1 Oct 1839	8	459
"	E 1/2 E 1/4	15	320	400.	" "	4115?	" "	8	460
Betsford, Jabez K.	E 1/2 NE 1/4	20	80	100.	5 June 1836	3313	" "	7	889
"	W 1/2 NW 1/4	21	80	100.	5 Jan 1836	3314	" "	7	890
"	E 1/2 SE 1/4	25	80	100.	27 Nov 1838	4672	20 May 1841	10	22
"	E 1/2 NE 1/4	36	80	100.	27 Nov 1838	4673	" "	10	25
Bowen, Sylvester	E 1/2 NE 1/4	6	80	100.	26 June 1835	2275	1 Oct 1839	5	183
"	SW 1/4 NE 1/4	35	40	50.	13 Dec 1849	28203	2 Dec 1850	56	390
"	NE 1/4 NW 1/4	35	40	50.	19 June 1847	25366	1 June 1848	Illeg.	
Butterfield, Nathaniel	E 1/2 SW 1/4	23	80	100.	27 Nov 1838	4679			

Government Land Office Records, Bremen Twp., contin.				Acres	Price	Pur. date	Receipt	Patent	V.	P.
Purchaser	Descr.	Ses.	Twp.							
Clark, Robert	W $\frac{1}{2}$ SE $\frac{1}{4}$ & E $\frac{1}{2}$ SW $\frac{1}{4}$	29		160	\$200.	25 June 1835	2265	1 Oct 1839	5	173
"	W $\frac{1}{2}$ NE $\frac{1}{4}$	29		80	100.	" "	2266	" "	5	174
Cooley, Germanius	SE $\frac{1}{4}$ SE $\frac{1}{4}$	12		40	50.	12 Nov 1849	28148	2 Dec 1850	56	349
Crandall, David	W $\frac{1}{2}$ SE $\frac{1}{4}$ & SW $\frac{1}{4}$	21		240	300.	26 June 1835	2268	1 Oct 1839	6	48
"	W $\frac{1}{2}$ SE $\frac{1}{4}$ & SW $\frac{1}{4}$	18		80	100.	4 Aug 1835	2644	" " (W.K.T.--)	5	209
"	W $\frac{1}{2}$ NE $\frac{1}{4}$	6		147	183.75	26 June 1835	2300	" " "	6	312
"	SW $\frac{1}{4}$	6		79.98	93.72	17 Aug 1835	2924	" " "		
"	E $\frac{1}{2}$ NW $\frac{1}{4}$	18		72.72	90.90	26 June 1835	2300	" " "		
"	E $\frac{1}{2}$ SW $\frac{1}{4}$									
"	W $\frac{1}{2}$ NE $\frac{1}{4}$	21		80.	100.	17 Aug 1835	2925	(Del. to W.K. Talbot)	5	209
"	NW frac	27		81.57	101.96	18 Feb 1837	4211	1 Oct 1839	5	311
"	SIDL, E $\frac{1}{2}$ frac	27		89	100.	27 Nov 1838	4670	" " "	9	58
"	SIDL, NW frac	27		27.13	33.91	6 May 1846	29605	20 May 1841	10	20
"	SW $\frac{1}{4}$ NW $\frac{1}{4}$	27		40	50.	6 Oct 1847	25029	30 March 1848	45	89
"	SE frac & NE $\frac{1}{4}$	28		27.87	34.84	6 July 1847	25461	1 May 1849	52	395
Doane, Seth P.	SW $\frac{1}{4}$	5		160	200.	13 June 1835	208	1 June 1848	51	266
Dyer, Thos. & Julius	W $\frac{1}{2}$ SW $\frac{1}{4}$	23		80	100.	9 July 1846	23442	Cancelled as per ltr. 28 Feb 1838		
"	E $\frac{1}{2}$ SW $\frac{1}{4}$	25		80	100.	27 Nov 1838	4710	" " "		
"	W $\frac{1}{2}$ SE $\frac{1}{4}$	25		80	100.	" "	4711	" " "		
Egan, William B.	SE & NW $\frac{1}{4}$	1		480	600.	26 May 1836	3768	1 Oct 1839	8	120
"	W $\frac{1}{2}$ NE $\frac{1}{4}$	1		80	100.	" "	3770	" " "	8	122
"	NW $\frac{1}{4}$	2		160	200.	22 July 1836	4040	" " "		
"	NE $\frac{1}{4}$	3		160	200.	" "	4040	" " "		
"	SE $\frac{1}{4}$	9		80	100.	11 Feb. 1836	3492	1 Oct 1839	7	360
"	SW $\frac{1}{4}$	9		80	100.	22 July 1836	4039	" " "	8	358
"	W $\frac{1}{2}$ SW $\frac{1}{4}$	10		80	100.	3 Dec. 1835	3274	" " "	7	151
"	W $\frac{1}{2}$ SW $\frac{1}{4}$ & SE $\frac{1}{4}$ SW $\frac{1}{4}$	10		5607	7700.	10 Feb 1836	3491	" " "	7	359
"	SE $\frac{1}{4}$ SW $\frac{1}{4}$	11		80	100.	27 March 1852	29623	2 Oct 1856--John Lewis	58	438
"	NW $\frac{1}{4}$	12		320	400.	26 May 1836	3769	1 Oct 1839		
"	E $\frac{1}{2}$ SW $\frac{1}{4}$	15		80	100.	2 Jan 1836	3283	" " "	7	153
"	E $\frac{1}{2}$ NE $\frac{1}{4}$	21		80	100.	" "	3284	" " "	7	159
"	NE $\frac{1}{4}$ & W $\frac{1}{2}$ SW $\frac{1}{4}$	28		240	300.	11 Feb 1836	3495	" " "	7	362
"	E $\frac{1}{2}$ SE $\frac{1}{4}$	30		80	100.	11 Feb 1836	3494	" " "	15	443
"				80	100.	" "	3493	" " "	7	361

Government Land Office Records, Bremen Twp., contin.

Purchaser	Desor.	Sec.	Acres	Price	Pur. date	Receipt	Patent	V.	P.
Sverton, Corintha	E 1/2 NW 1/4	8	80	\$100.	26 June 1835	2299	1 Oct 1839	5	207
" , Sam'l	E 1/2 SW 1/4	8	80	100.	" "	2337	" " "	5	204
Fairfield, Albert B.	E 1/2 NE 1/4	13	80	200.	8 June 1853	30102	" " "	"	"
Fischer, Peter H. et al	NE SE & SE NE	11	80	200.	" " "	"	" " "	"	"
Foyt, Peter	NE NW	25	40	50.	4 Jan 1850	28230	24 Nov 1852	56	415
Frohn, Hans H.	E 1/2 SW 1/4	24	80	100.	6 Nov 1848	27541	" " "	"	"
Garrand(?), Learnd?	SE 1/4 & S. Frao SW 1/4	22	176.99	221.24	8 July 1846	23413	1 March 1848	47	136
Garrett, Augustus	NW 1/4	4	160	200.	28 Nov 1835	3075	1 Oct 1839, F. Garrett	"	"
Garrett, Augustus	N 1/2 NE 1/4	5	80	100.	" " "	3074	O.H. Thompson, N.J.	6	458
Gard, Leonard	NE 1/4	27	160	200.	8 July 1848	23412	Brown, Dr. Ballard	6	457
" "	SE 1/4	27	160	200.	10 July 1848	23455	Ditto	47	135
Goodrich, Grant & McMartin, James	W 1/2 SW 1/4	1	80	100.	5 Jan 1836	3315	10 Oct 1839	7	191
Graves, Millard	NW fr. SIBL	13	29.41	73.53	22 Dec 1855	24971	Springfield Off.	5	191
Griffin, Sylvester	E 1/2 NW 1/4	21	80	100.	4 Sept 1835	2958	1 Oct 1839	5	346
" "	SE 1/4 NE 1/4	30	40	50.	" " "	2960	" " "	6	384
Haddeck, Edward H. & Mason, John C.	E 1/2 NW 1/4 & W 1/2 NE 1/4	17	160	200.	7 Aug 1835	2819	" " "	"	"
Hale, Isaac	NW 1/4	5	160	200.	13 June 1835	2338	1 Oct 1839	"	"
Heacock, Russell E.	E 1/2 NE 1/4	1	80	100.	26 June 1835	2257	(Charles H. Chapman)	5	295
Henk, Frederick	W 1/2 NE 1/4	34	80	100.	1 Sept 1846	23841	1 Oct 1839	5	165
Henke, Henry	NE 1/4 SW 1/4	33	40	50.	15 May 1849	25----	1 Feb 1848	48	19
Henrits, Henry	SW 1/4 SE 1/4	34	40	50.	7 Nov 1848	27590	" " "	"	"
" "	NW 1/4 SE 1/4	34	40	50.	29 June 1849	27816	6 March 1850	55	342
Hockmann, Christopher	W 1/2 SE 1/4	34	80	100.	20 Oct 1847	26131	2 Dec 1850	56	136
Hotfard(?), Frederick	W 1/2	14	320	400.	18 Nov 1836	4151	1 May 1849	52	458
Huel---, Robt. (7)	W 1/2 SE 1/4	28	66.52	83.15	31 May 1847	26131	1 Oct 1839	8	465
Mupe, Laborius	W 1/2 NW 1/4	35	80.	100.	17 May 1846?	23717	(Francis G. Blanchard)	52	458
Ingersoll, Chester	W 1/2 NW 1/4	17	80.	200.	15 Aug 1835	2921	1 March 1849?	49	457

Purchaser	Descr.	Sec.	Acres	Price	Pur. Date	Receipt	Patent	Vol. P.
John, Jehn Crist	NE 1/4 NE 1/4	34	40	\$ 50.	17 Aug 1846	23708	1 March 1848	47 409
Jones, William	SE 1/4	8	160	200.	5 Aug 1835	2698	1 Oct 1839	6 96
Kammel, Frederick	SE 1/4 NW 1/4	35	40	50.	10 July 1847	25551		
Karstens, John	NW 1/4 SW 1/4	24	40	50.	17 Aug 1848	27266	7 March 1850	55 101
Keinzle, I.H. & Pearson, - - -	NW 1/4 & W 1/2 SW 1/4	15	240	300.	26 June 1835	2576		
Kellar, Valentine	S 1/2 SW 1/4	23	80	100.	9 July 1846	23442		
Kerwa-, Gholson	NE 1/4 & frac 1/2	22	407.22	509.12	5 May 1836	3704		
Kintz, Frederick	SW 1/4 NW 1/4	25	40	50.	11 July 1848	27188	1 March 1850	55 31
Knersch, Frederick	NW 1/4 NE 1/4	25	40	50.	8 June 1849	27854		
Knodd, Charles	SE 1/4 NW 1/4	23	40	50.	17 Sept 1849	28026	2 Dec 1850	56 245
Lalster, Wm.	SW 1/4	3	160	200.	24 Nov 1836	4155	1 Oct 1839	8 469
Lane, Devitt	NE 1/4	9	160	200.	30 June 1836	4001	1 Oct 1839	8 374
"	SW 1/4	9	160	200.	11 Aug 1836	4076	1 Oct 1839	8 394
"	E 1/2 NE 1/4	17	80	100.	5 Sept 1836	4096	1 Oct 1839	8 412
Letz, Herman	SE 1/4 SE 1/4	23	40	50.	25 Aug 1849	27986	2 Dec 1850	56 209
Lewis, John	S 1/2 SE 1/4	11	80	200.	9 March 1853	28982		
"	NW fr. 1/4, N1/2L	13	101.21	253.02	30 June 1853	30126		
"	(Land War.) NE 1/4 NW 1/4, S1/2L	23	146.55	- -	30 Oct 1849	27381	10 Aug 1850	38 469
"	& W 1/2 NE 1/4	23	.2625	- -	12 March 1853	28989	1 Aug 1853	57 454
"	NW Fr. N1/2L, SW	23	80.	200.	9 Aug 1853	29253		
"	SE NE & NE SE	23	77.68	Warr.	30 May 1853	32565		
"	S fr. 1/2 SE 1/4	31	32.91	41.14	6 Oct 1852	28544	1 Aug 1853	57 425
"	N 1/2 Lot 2 NW 1/4	31	33.14	Warr.	13 Oct 1852	34528		
"	W 1/2 Lot 2, SW 1/4	31	32.91	"	18 Oct 1852	58534		
"	S 1/2 Lot 2, NW 1/4	31/32						
"	S 1/2 Lot 1, NW 1/4;	31	160.	Warr.	22 Oct 1852	59599		
"	N 1/2 Lot 1, SW 1/4; NW 1/4 SE 1/4	31	40.	"	"	33714		
"	N 1/2 Lot 1, NW 1/4	31	73.14	"	21 Dec 1852	36020		
"	S 1/2 Lots 1 & 2, SW 1/4	31	16.21	40.55	12 March 1853	28999		
"	S frac. NW 1/4	33	16.	- -				
"	- frac. NW 1/4	33		- -				
Magee, James H.	NE 1/4	2	160.	200.	9 July 1836	4013	1 Oct 1839	8 332
Magnus, Ahler	W 1/2 NW 1/4	34	80.	100.	1 Sept 1846	23840	1 Feb 1848	48 18
"	E. & Mills, Henry	33	80.	200.	10 Sept 1852	25790		
"	E 1/2 NW 1/4	34	80	100.	1 Sept 1846	23939	1 Feb 1848	48 17

<u>Purchaser</u>	<u>Descr.</u>	<u>Sec.</u>	<u>Acres</u>	<u>Price</u>	<u>Pur. Date</u>	<u>Receipt</u>	<u>Patent</u>	<u>Vol.</u>	<u>P.</u>
Mad---, Carl	SE $\frac{1}{4}$ NE $\frac{1}{4}$	34	40	\$50.	16 July 1847	25558	- - - - -	- - - - -	- - - - -
Martin, Edward	E $\frac{1}{2}$ SW $\frac{1}{4}$	4	80	100.	2 July 1836	4010	1 Oct 1839	0	309
Mason, John & Edna H.	E $\frac{1}{2}$ NW $\frac{1}{4}$ & W $\frac{1}{2}$ NE $\frac{1}{4}$	17	160	200.	7 Aug 1835	2819	- - - - -	- - - - -	- - - - -
McClintock, Thomas	W $\frac{1}{2}$ SE $\frac{1}{4}$	5	80	100.	13 June 1835	197	- - - - -	- - - - -	- - - - -
"	E $\frac{1}{2}$ NE $\frac{1}{4}$	8	80	100.	26 June 1835	2322	- - - - -	- - - - -	- - - - -
"	W $\frac{1}{2}$ NE $\frac{1}{4}$	8	80	100.	" "	2323	- - - - -	- - - - -	- - - - -
"	W $\frac{1}{2}$ NW $\frac{1}{4}$	9	80	100.	" "	2321	- - - - -	- - - - -	- - - - -
Benj. & Reuben - -	W $\frac{1}{2}$ NE $\frac{1}{4}$	13	80	L.W.	25 June 1855	9177	(Very sm. writing)	S./IM	- - - - -
McMartin, James & Goodrich, Grant	W $\frac{1}{2}$ SW $\frac{1}{4}$	29	80	100.	5 Jan 1836	3315	10 Oct 1839	151	- - - - -
Mejor, Frederick	W $\frac{1}{2}$ SW $\frac{1}{4}$	35	80	100.	18 Oct 1847	26124	1 May 1849	58	477
Merrill, Geo. W. & William, Geo. W. & Miller, Henry & Mary E.	W $\frac{1}{2}$ NE $\frac{1}{4}$ NW $\frac{1}{4}$ NE $\frac{1}{4}$	6 35	80 40	100. 50.	26 May 1836 19 June 1847	3797 25367	1 Oct 1839	8	149
Newberry, Walter L.	NE $\frac{1}{4}$	2	160	200.	6 March 1837	4236	1 Oct 1839	9	15
"	W $\frac{1}{2}$ NW $\frac{1}{4}$	6	74.93	93.66	26 June 1835	2357	" "	5	218
Noble, Moriah	- $\frac{1}{2}$ SW $\frac{1}{4}$	5	80.	100.	10 July 1845	19245	18 Feb 1848	39	60
"	W $\frac{1}{2}$ SW $\frac{1}{4}$	8	80.	100.	26 June 1835	2295	- - - - -	- - - - -	- - - - -
Sawtoll, D.	NW $\frac{1}{4}$ SE $\frac{1}{4}$	30	40.	50.	3 Oct 1849	28005	- - - - -	- - - - -	- - - - -
Ocher, Martin	W $\frac{1}{2}$ NE $\frac{1}{4}$	6	80.	100.	28 May 1836	3797	1 Oct 1839	8	149
Osborn, William & Merrill, Geo.	SW $\frac{1}{4}$ NE $\frac{1}{4}$	25	40.	50.	23 May 1848	26967	- - - - -	- - - - -	- - - - -
Pearson, " " & Keinzie, I. H.	NW $\frac{1}{4}$ & W $\frac{1}{2}$ SW $\frac{1}{4}$	15	240.	300.	26 June 1835	2576	- - - - -	- - - - -	- - - - -
Peck, Ebenezer	NW $\frac{1}{4}$	3	160.	200.	23 July 1836	4044	- - - - -	- - - - -	- - - - -
Prague, Peter	E $\frac{1}{2}$ NE $\frac{1}{4}$	5	80	100.	7 Aug 1835	2828	- - - - -	- - - - -	- - - - -
Quon---, Sebastian	SE $\frac{1}{4}$ NE $\frac{1}{4}$	25	40.	50.	23 May 1848	26967	- - - - -	- - - - -	- - - - -
Rathe, John Henry	E $\frac{1}{2}$ SW $\frac{1}{4}$ & W $\frac{1}{2}$ SE $\frac{1}{4}$	35	160	400.	16 July 1853	29176	- - - - -	- - - - -	- - - - -
Berner(?), Bernard	S frac NE $\frac{1}{4}$	22	29.79	37.24	6 July 1847	25477	- - - - -	- - - - -	- - - - -
Rexford, Norman	W $\frac{1}{2}$ SE $\frac{1}{4}$	6	80.	100.	26 June 1835	2306	1 Oct 1839	5	214
"	E $\frac{1}{2}$ SE $\frac{1}{4}$	7	80.	100.	" "	2305	" "	5	213
"	E $\frac{1}{2}$ NE $\frac{1}{4}$	16	80.	100.	" "	2307	- - - - -	- - - - -	- - - - -
Rexford, Stephen	W $\frac{1}{2}$ NE $\frac{1}{4}$	7	80	100.	" "	2241	1 Oct 1839	5	149
"	E $\frac{1}{2}$ NW $\frac{1}{4}$	7	73.51	91.88	12 " "	132	" " "	1	130

Purchaser	Description	Sec.#	Acres	Price	Pur. Date	Receipt	Patent Date	Vol.	Page
Rexford, Stephen	W 1/2 SE 1/4 & E 1/2 SW 1/4	7	152.58	\$190.72	26 June 1835	2242	1 Oct 1839	5	150
Rust, Phineas B.	E 1/2 & SW 1/4 NW 1/4	13	120.	300.	18 June 1853	30113			
Rust, Frederick R.	SW 1/4 NE 1/4	25	40.	50.	21 Aug 1847	25736	1 June 1848, F. Kirk		25
"	SE 1/4 NW 1/4	25	40.	50.	27 "	25763	" "		52
Savtall, David & Noble, Wm. B.	W 1/2 SW 1/4	8	80	100.	26 June 1835	2295			
"	W 1/2 NW 1/4	8	80	100.	" "	2296			
Scott, Leonard G. (?)	W 1/2 NW 1/4	7	73.51	91.88	12 "	133	1 Oct 1839	1	131
"	NW 1/4	18	165.68	182.10	26 "	2262	Do., David Demey	5	170
"	W 1/2 SW 1/4	7	72.58	97.987	" "	2261	" "	5	169
Selvey, Henry	NE 1/4 SW 1/4	27	40.	50.	4 Aug 1848	23621	1 March 1878	47	323
Shafor, Augustus Wm. (War.)	S 1/2 SW 1/4	13	80.	War.	9 June 1853	47244	S. I. R. L.		
"	N 1/2 SW 1/4	13	80.	"	" "	463447	" "		
Steel, Henry	SE 1/4 SW 1/4	27	40.	50.	2 Sept 1848	23655	1 Feb 1848	48	32
Stellar, Frederick	E 1/2 SW 1/4	34	80.	100.	1 July 1849	27924	2 Dec 1850	56	157
Stellar, Phillip (Land War.)	Lots 1 & 2 NW 1/4	30	145.99	"	25 July 1849	45940			
Stott(?), Henry	SW 1/4 SW 1/4	27	40.	50.	24 May 1847	25197	1 June 1848	48	6
Suan, Alfred	SW 1/4 SE 1/4	30	40.	50.	22 Apr 1850	28203			
Talbott, Malham K.	SE 1/4 & W 1/2 SW 1/4	18	232.77	290.90	4 Aug 1835	2645	1 Oct 1839	6	48
Taylor, Joseph T.	SE 1/4	13	160.	400.	8 June 1853	30101			
Vay, Ewald & Vogt, Henry	NW 1/4 NW 1/4	25	40.	50.	16 Aug 1847	25702	1 June 1848	51	561
Vogt, Henry & Weber, Leopold	NW 1/4 SW 1/4	27	40.	50.	18 July 1848	23521	1 March	47	239
Wadhams, David	W frac. N. 1/4 NW 1/4	23	40.	50.	27 Aug 1846	23810	1 March 1848	47	489
"	S frac. NW frac. ?	23	25.58	31.97	2 Jan 1847	25246	1 June 1848	51	55
"	Frac. NW 1/4 NW 1/4	23	26.32	35.40	10 July 1847	25511	" "	51	316
"	SW 1/4 NW 1/4	23	40.	50.	27 June 1848	27316	10 Sept 1849	54	455
Wadsworth, Julius & Dyer, Thomas	W 1/2 SE 1/4	23	80.	100.	27 Nov 1838	4711			
Weld, Henry	E 1/2 SE 1/4	28	80.	100.	31 May 1847	25238	1 June 1848	51	47
Wersfelman, Dietrich	W 1/2 SW 1/4	34	80.	100.	7 Oct 1847	26027			
White, Philo	W 1/2 NE 1/4 & NW 1/4 NE 1/4	30	120.	150.	21 June 1836	3956	1 Oct 1839	8	275
Wille, Henry & Magnus, E.	W 1/2 SW 1/4	33	80.	200.	10 Sept 1852	25790			
Zacharias, Frederick	NE 1/4 NE 1/4	23	40.	100.	25 Oct 1853	29256			

Note: Some sections in Bremen Township are crossed by the old Indian Boundary Line (I.B.L.) (See map, p. 1)  
This results in fractional tracts of land either north or south of this line.

LAND WARRANT PATENTS--ELEMEN TOWNSHIP

Patentes	Description	Sec.#	Acres	War.Date	Receipt #	Patent Date	Vol.	Page
G... Thomas P.	SE 1/4	3	160	18 Dec 1849	46965	10 Aug 1850	30	331
Heine, Henry	SE 1/4	30	160	25 May 1848	15188	1 Sept 1849	14	424
"	SW 1/4	2	40	11 Dec 1849	36495	10 Aug 1850	38	70
"	SE 1/4	11	80	" "	38445	" "	38	702
"	SW 1/4 S1/2	14	31.15	30 Oct 1849	27381	" "	38	469
"	W 1/2 S 1/4	25	80	2 ? 1848	19635	7 Apr 1849	15	137
"	E 1/2 NE 1/4 & E 1/2 SW 1/4	35	160	20 Jul 1848	15675	7 Aug 1849	17	33
"	W 1/2 SE 1/4 & E 1/2 SW 1/4	35	160	13 Nov 1848	22228	" "	"	"
"	SW 1/4	35	160	18 Mar 1848	19307	7 June 1849	2	180
"	SE 1/4	35	160	20 Jul 1848	19884	10 Aug 1849	17	85
"	W 1/2 NE 1/4 & E 1/2 SE 1/4	36	160	2 Aug 1848	19629	7 Apr 1849	15	138
"	SE 1/4 NE 1/4	36	80	" "	19535	" "	15	137
... Andrew (?)	NE 1/4	33	160	19 June 1848	16258	1 Sept ?	5	245
R... , Howard	W 1/2 SE 1/4 & E 1/2 SW 1/4	19	--	18 Dec 1849	--	--	--	--
Steinhous, Augustus	NE 1/4 S1/2	33	145.84	11 Nov 1847	3570	1 Feb 1848	6	255
"	E 1/2 SW 1/4	2	89.	16 Nov 1849	53671	10 Aug 1856	30	25
"	NE 1/4 SW 1/4	11	40	14 Nov 1849	53671*	" "	"	"

Note: Section 16 was reserved for the common schools; portions of Sections 2, 12, 14, 24, 28 and 32 were reserved for the common schools.

## BACHELORS GROVE CEMETERY

Contributed by Earnest WILKINSON

The following information about the Bachelors Grove Cemetery is an excerpted part (pp.25--30) of the Bremen High School Bicentennial History Project, which was a joint effort of Bremen High School District 228, the Midlothian Bicentennial Commission and the Bremen High School '76 Local History Research Team, with the research actually done by the latter.

Cemeteries are viewed in many ways by different people and at different times. Among the most civilized people, it is considered sacred ground. While the relatives of the dead live on, they pay occasional homage to the memory of the lives of those now dead and buried (whom we will all join some day) by decorating and making beautiful the last resting place of those who touched their still living spirits, when these dead once lived, loved, toiled, laughed, cried, and experienced these things we all think and feel.

What happens to the cemetery when the loved ones move away, or die, or become so few, or helpless, that the sacred ground can no longer be cared for? Who cares?

A few years ago, two active members of the trustees of the Bachelors Grove Cemetery, Mr. Clarence FULTON of Tinley Park, yet living, and Mrs. Dorothy ANDERSON, recently deceased of Midlothian, told of their Sunday visits to that cemetery when they were children. The area, they reported, was like a "park", with a small quarry pond for recreation nearby that served as both a fishing and swimming hole. The natural beauty of the little plot of land was well known. The remnants of rose and lilac bushes, pine trees, violets, ground cover and wild lilies give a suggestive evidence of a beauty that graced the scene.

Now, empty beer cans, half-dug holes, desecrated tombstones and missing headstones testify to a vandalism of an unbelievable kind that is obliterating this final resting place of some of our better known and some of our lesser known but honorable, pioneer dead. These benighted perpetrators of this kind of needless violence have shown a complete disregard for a precious historical, if no other, link between our local area's pioneer past and our present.

Although there is no knowledge of the exact age of Bachelors Grove Cemetery, some "old-timers" have recalled headstones with "1832" and "1838" datings of deaths, that are now missing. A tombstone bearing a death date of 1848 does still remain in the cemetery, probably due to the fact that it was too large to be easily carried away by vandals.

The 1848 stonewould predate the first legal record on title deeds of the plot of land being set aside as a grave-yard in 1864. However, the first evidence of private ownership of the land was in 1835. If the "1832" stones could be recovered, or burials otherwise verified, it could suggest that burials could have been made as early as the Blackhawk War.

In 1864, when Edward EVERDEN sold his land to Frederick SCHMIDT, EVERDEN set aside one acre of the land to be used as a graveyard, which it has remained ever since, until burials became too risky because of vandalism. The latest known

burial, according to remaining headstones, was in 1965, eleven years ago.

From the remaining headstones that were found in the cemetery this year, several could be those of persons of known historical prominence. For example, Walter PATRICK, a scotsman by birth, had the highest valued real estate in Bremen Township, according to the U.S. Census of 1850. The large FULTON family plot tombstone, the largest remaining in the cemetery, is believed to mark the burial of John FULTON, the eldest son of the pioneer John FULTON, who came from Ireland, and eventually had one of the largest families, and largest land holdings, in the township. Delany HULETT HCKEE, born in 1855, taught school in the one story Old Stone Schoolhouse, probably in the Civil War era. The stone building, on the north side of 147th Street, just east of Central Avenue, has been modified to become a private residence. There is some, yet unverified, evidence that at least two Civil War veterans were buried in the Bachelors Grove Cemetery.

The following is the product of several readings of Bachelors Grove Cemetery, by American History students of Bremen High School, Middlothian, Illinois, since 1971:

DECK, Bernard F. 1876--1949	HANNA, Tom Patrick * 1848--1872	NI(C)K(A)LAS, Joseph * 1871--1921
DECK, Mary D. * 1841--1921	MENDERHALL, Wm. Frank 1889--1933	NEWMAN, Daniel (Husband) * 18 April 1871-12 Dec 1947
DECK, Jacob * 1840--1915	HCG(H)EE, Laura H. 1887--1965	NEWMAN, Dora (Wife) * 25 July 1870-8 Oct 1948
FULTON (Father) * 1838--1922	HCKEE, Delany H. 18 Sept 1855-16 Apr 1920	PATRICK, Walter * Died: 1 Jan 1880 Age: 10 yrs. 10 mos. 11 da.
FULTON, Robert * Sep. 26, - - - -	HCKEE, James W. 8 Oct 1845-21 July 1911	PATRICK, Walter Died: 18 -- 1887 Age: 67 yrs. 1 mo. 11 da.
FULLERTON, - - - - -	MCMURRAY, Jane * 1831--1911	RIPPET (no dates)
FOSKETT, Alva O. 11 Feb 1871-9 March 1960	MCMURRAY, Robt. * 1830--1909	ROGERS, D. W. 1867--1923
FOSKETT, Caroline S. 14 Aug 1880-29 April 1934	HOSS, Isabella * (Wife of T.W. HOSS, Sr.) Died: 27 March 1848, Age: 29 yrs. (Born 1819)	ROGERS, (Luella?) * Infant daughter
HAGENAN, Charles 4 June 1841-15 March 1924	HOSS, Maria H. * 1854--1918	SHIELDS, James H. 18 Apr 1865-1 June 1918
HAGENAN, Minna 24 Dec 1847-10 Nov 1894	HOSS, Richard E. * 1859--1934	SHIELDS, Sarah H. 10 Dec 1841-22 Dec 1924
HAMILTON, Alma G. 9 June 1857-7 June 1954	NI(C)K(A)LAS, Jenny * 1871--1921	SHIELDS, Wm. H. 1839--1922
HAMILTON, William 1865--1903		

WARREN, Amazetta Curtis  
1862--1901

WHEELER, Chauncey B.  
Jan 1852 -- Jan 1929

WARREN, Mark Ichabod  
1853--1904

WHEELER, Ella Fulton \*  
April 1856 -- May 1928

It is hoped that very soon this little acre of sacred ground will be dealt with in such a way that it can provide both a historical, as well as a recreational purpose. How that may be accomplished is still a question. It will take knowledge, dedication, hard work and much widespread cooperation, and good will, to eliminate the most recent degradations of this, one of the oldest known--perhaps the oldest known--private burial grounds in the State of Illinois.

Editors Note: The headstones in the above listing marked with an asterisk (\*) were no longer in the cemetery when we visited the scene in September, 1976. On a second visit just two weeks later, other stones were missing, and only the huge FULTON monument remained intact. However, on our first visit we were able to read two inscriptions not on the above list:

MOSS, Thomas W.  
11 Feb 1811-11 March 1885

PATRICK, W-----, w. of Walter  
(dates illegible)

\* \* \* \* \*

THE IMPORTANCE OF FAMILY HISTORY

(From an address by Prof. H.C. KING of Oberlin College made at LEE family Reunion in 1896)

For a better understanding of ourselves, the study of family history is important. Many a puzzle in one's psychological make-up would be far easier of solution if we knew our ancestors better. It is of value to know the family characteristics in their strength and their weaknesses. Every motive of love and respect urges that one know the entire lives of at least his father and mother well. I wish I might persuade every person to whom it is still granted the presence of father or mother to secure from them carefully written accounts of their lives. These accounts would be priceless documents and they would grow in preciousness with one's years. . . . .

The Chinese reverence for ancestors has a much better philosophical basis than the more common reverence for places. The sacredness of all places and things is borrowed from persons. We do well to recall in filial affection the names and lives of those who have gone before us, from whom we have come. Every name in the most skeletal genealogy still stands for a life history; and a little loving imagination re-clothes the barren name with the beauty and fragrance of a life passionately loved--loved as we love life. They, too, lived and loved, hoped and aspired, they too were disappointed and defeated, and had their moments of achievement and conquest. And from the study of their lives we turn with chastened ambition and a more tender sympathy to take up our allotted task, with its inherited limitations, glad of our living connection with the lives of years gone by.

## WHERE HAVE ALL THE GRAVESTONES GONE?

by

Mary Ellen Gifford

**VANDALISM** The above title is borrowed from a feature article by Patricia **STEMPER** which appeared in the Chicago Tribune on April 12, 1970. Speaking of vandalism, she quotes a Cook County Sheriff's Department spokesman, "There has been a 50 per cent increase in the number of vandalism incidents that have occurred in cemeteries in recent years."

Anyone who has visited a cemetery recently has seen sickening proof that this morbid form of amusement is increasing. A friend of mine who manages a beautiful old cemetery in Will County tells of the staggering amount of money the Association must pay for tombstone repairs on a monthly basis. One is tempted to make a stereotyped observation and say "Today's youth has no respect for history or humanity!"

**TEACHING CEMETERY** This caption on an article in the Oakland (Calif.) Tribune, June 30, 1976, p. 60, calls attention to a vastly different sort of youth activity. The dateline is Philadelphia (AP) and it is the heart-warming story of "Operation Cemetery", a project of the E. Washington Rhodes Middle School in North Philadelphia. Edward STRANIX, an administrator at Rhodes, first thought of using cemeteries as outdoor classrooms for inner city children about three years ago.

"The cemetery is a safe, open and available area for making discoveries," STRANIX says. "A youngster can catch toads, collect rocks and observe butterflies." He sees cemeteries as perfect outdoor classroom-laboratories.

Some of the out-growths of "Operation Cemetery" have been extended research projects into the Civil, Spanish-American and two World Wars. Several children have looked into the history of families buried in the cemetery. Others have made rubbings of gravestones for an art class.

**GOOD TEACHING AT BREMEN** Mr. Earnest WILKINSON, a Bremen High School history teacher (and a member of S.S.G.H.S., we are proud to say!) has utilized a cemetery in a different way--under his guidance, Bremen students have preserved the history carved in stone at Bachelors Grove Cemetery. We are pleased to include their findings in this publication. (p. 19) This research was timely; the pictures on the facing page point up the urgency of such work.

**THE MORAL OF MY STORY** What can we do about this mindless vandalism of cemeteries? May I suggest two positive approaches:

- (1) **TEACH** an appreciation for history to all the young people you know-- your own children, nieces, nephews, grandchildren, the neighbor children, the newsboy. It's a sure bet that none of Earnest WILKINSON's students will ever desecrate a cemetery. However, the teaching process takes time, so
- (2) **READ** and **RECORD** the records chiseled in stone. Every **HISTORICAL** and **GENEALOGICAL** group in the country should be laying plans now for recording sessions next summer. Let's save our cemetery records!

\* \* \* \* \*

"Life, life is the tillage, and Death is the harvest according."

Walt Whitman--Leaves of Grass

TABLE FOR COMPUTING BIRTH DATE

When death date and yrs, mos, days of life are given.  
 (Adapted by John D. Gifford from William Sausaman, Springfield, Ill.)  
 (Tri-State Trader 4 May 1974)

To use:

- 15 1. Find day of death in lower part of left column.
- 16 2. Treating this day as 0, the day before as 1, the day
- 17 before that as 2, etc., count up the column according
- 18 to the number of days given. (If the number of days was
- 19 over 15, it will take you into the preceding month. Re-
- 20 member "Thirty days hath September, April, June and
- 21 November") (For February, see below)
- 22 3. In the lower part of the Month column, find the month ob-
- 23 tained in Step 2. Counting this month as 0, figure back
- 24 the number of months given. (If you go past January 1,
- 25 subtract 1 from year of death)
- 26 4. Take the year obtained in Step 3 and subtract the years
- 27 given in data.

28 January

29 February

30 March

(31) April

1 May

2 June

3 July

4 August

5 September

6 October

7 November

8 December

9 January

10 February

11 March

12 April

13 May

14 June

15 July

16 August

17 September

18 October

19 November

20 December

21

22

23

24

25

26

27

28

29

30

31

Example I: Subject died 17 Feb 1909, aged 61 years, 9 months, 27 days.

1. Starting with 17 in lower part of column, count back 27 days. Since January was the preceding month, we use the 31. This step brings us to January 21.

2. Starting with the January in the lower part of month column, count up 9 mo. This takes us to April. (We did go beyond Jan 1 so 1909 becomes 1908.)

3. Subtracting 61 from 1908 gives 1847. Hence subject was born 21 April 1847.

(It is always a good idea to check your work by starting with subject's computed birth date and count forward with the date that was given.)

Remember: In Leap Years (those divisible by 4) February has 29 days, otherwise 28.

Example II: Subject died March 5, 1904, aged 19 yrs., 7 mo., 10 da.

1. Starting at 5, count up 10 days. The month preceding March is February and this was a Leap Year so we skip the 30 and 31. Thus we land on the 24.

2. 7 mo. back from February takes us to July 1903 (Since we went beyond Jan 1).

3. Subtracting 19 from 1903 gives 1884. Hence subject was born 24 July 1884.

INDEX - 1860 CENSUS  
BREMEN TOWNSHIP, COOK COUNTY, ILLINOIS  
 (Transcribed and indexed by John D. Gifford)

This alphabetical index of surnames includes heads of families and names of persons having surnames which differ from the head of the family. The numbers refer to dwellings. The census was copied exactly as it appears on the original, in numerical order from dwelling and family 473-458 to 745-718. It takes up 35 pages in the enumerators book. The work was done in June 1860 and the enumerator was Emil d'Orville. The P.O. given was Bremen Station.

Space prohibits the inclusion of the entire census listing in this quarterly but copies are available from S.S.G.H.S. for \$2.50.

Alm. Chs.	738	Clark, James	721	Ernst, Gottfried	547
Altenburg, August	743	Clausen, Ehrich	491	Everben, Samuel	699
Andrews, T.	711	Coll, William	593		
Anis, Fredr.	635	Cool, Benjamin	598	Fay, Edward	509
Anthony, Herbert	701	Coon, Wm. M.	705	Feigel, George	740
Aston, Robert	703	Cosin, Cathr.	704	Fentzler, George	672
Balze(?), Gabriel	546	Cott, Henry	559	Fiero, John	503
Bartels, George	651	Crandall, Heman	707	Flacher, Henry	728
Be--dd, O. T.	597	Crandell, Marc	596	Flassig, F.	613
Becker, Ludwig	498	Crandels(?), William	695	Fleischer, Fredr.	567
Beers, William	598	Crow, Thomas	501	Flins(?), Daniel	503
Beger, Martha	653	Cott, George	568	Flower, Jonathan	600
Benger, Frdr.	724			Franz(?), Fredr.	473
Berg, Charles	669	*Downy, Peter L.	484	Friathel, Henry	627
Bernchen, Fredr.	570	Dale, Samuel	519	Fulton, Hamilton	705
Betscher(?), Fredr.	584	Deiske(?), Gottfried	528	Fulton, John	655
Bieber, Henry	634	Deiss, Charles	676	Funk, Gebhard	556
Bitter, Joachim	496	Deist(?), Gottfried	656		
Blume, Chas.	571	Dichmann, Fredr.	532	Gantz, Lorenz	712
Blumenthal, Ernst	492	Diener, George	490	Geely(?), William	673
Boenicke, Dorothea	530	Diers, Frd.	610	Geiler, Friedr.	545
Boetcher, Christian	599	Domeyer, Anton	596	Gele, Claus	687
Brand, Louis	523	Domeyer, Louisa	588	Geler, Mary	574
Braun, Henry	524	Dorn, Dellos(?)	719	Gerstenkorn(?), Frd.	624
Breitung, Thobias	742	*Dorn, Henry	732	Gerstenkorn, Mina	581
Briggs, Harris	601	Droming, Carston	596	Gerstenkorn, Wm.	625
Britt, Henry	717	Dunsing, Henry	666	Gilson, Daniel	745
Büicke(?), Wesly	591			Gleson, Mary	601
Burkholz, Fritz	670	Ehlers, Henry	604	Gochon(?), Frd.	609
Burkner, John	619	Einebohr, Peter	537	Goedicke, Charles	539
Bushest(?), Nicolaus	690	Einspach, Frdr.	612	Goeleen, Claus	474
Busse, John	538	Eisenberg, John	586	Golding, Marian	645
		Eisenhardt, Wm.	498	Graef, John	500
Cague, John	590	Eisinger, John	640	Grahn, Fredke.	576
Cague, John F.	563	Ellert, John	606	Greseler, John	489
Carley, Alphonse	588	Emma, Herbert	721	Groll, John	568
Carley, William	728	Engeland, Peter	474	Grossguth, Jacob	678
Carroll, John	598	Engelhard, Frd.	686	" , John	656
Carstens, John	499	Engelhardt, Nicolaus	558	" , Wm.	683
Clange, Charles	555	Erber, Frder.	697	Gruenhagen, John	573
Clark, Calvin	699	Ernst, David	676	Guenert, Henry	479

Gurrad, Lorenz	671	Krahn, Christoph.	512	Mueller, Henry	523
" , Leonhard	564	Kranz, Friedr.	473	" , Mina	506
Habard, John	517	Lachner, Henry	565	" , Valentin	484
Hache, Carl	664	Lahn(Lawn?), Henry	590	" , William	511
Haman, Helena	621	Lambke, Wm.	571	Muhlhaner, George	642
Hamilton, Wm.	704	Laun(Lawn?), Henry	713	Munn, Christian	688
Harms, Frd.	531	Lee, John	527	Murphy, O.	716
Hartung, John	647	Leitz, Fritz	659	Newman, George	701
Hartwig, Otto	652	Leorenz(?), John	696	Noble, George	697
Hatch(?), John	689	Leverenz, John	585	" , Mary	703
Heim, John	493	Leyfarth, Fredr.	502	Noley, Patrick	710
Hensch, Friedr.	549	Lichman, Henry	551	Nolin, Peter	643
Herman, Christ.	530	Liebrand, Frdr.	667	Norfelmann, Frd.	533
Hermann, Peter	535	Littig, August	543	Oelin, Mary	630
Hermening, Henrithe	521	Lohmocker, Dietrich	606	Ogdenburg, Frdr.	630
Hildebrand, Fedr.	588	Lohring, John	681	Ohnen, John	577
Hochler, Henry	582	Lorenz(?), John	696	Olfke, Henry	706
Hoehm(m?)e, Ludwig	595	Lowerenz, Ewald	586	Orhen(?), A. W.	514
Hofman, Henry	674	Ludwig, Jacob	548	Orker(?), Martin	495
Hofmann, John	532	Madelon, Chas.	595	Otto, Christoph	572
Hofmeister, Gottfried	515	Maier, Henry	580	Paine, M. Th.	680
" , John	652	Manke, Christian	544	Patrick, Robert	696
Hon, George L.	653	Marr, Mary	596	" , Walter	721
Honeywell, Wm.	702	Mass, Philipp	506	Pauling(?), Dietrich	506
Hopkins, John	630	Matthews, Fdr.	658	Pecht, Gottlieb	504
" "	677	Mayer, Albert	523	Pemhof, Gerhard	580
" "	700	Mayer, Chas.	520	Penasky(?), Wilhelm	720
" , Patrick	649	Mayerhofer, Herm.	581	Pohl, August	534
Hulett, David	700	McGuy(?), Allen(f)	697	Polten, Henry	583
Hunstock, Gottl.	733	McKey, Elis.	703	Praetorius, John	536
" , John Chr.	575	" , Joseph	700	Quittmeyer(?), Henry	566
Hunt, Chas.	601	McLane, John	736	Raade, John	604
" , Joseph	603	McLinden, James	714	Rech, Adam	473, 485
Hupe, Lycurgus	529	" , Pat.	715	Reibolla(?), Alex.	527
Ihlfeldt, Fredr.	487	Meinheidt, Friedr.	574	Reich, Anton	690
Jauchzer, Herman	661	Menk, Charles	656	Reichard, Chs.	727
Jebens, Claus	497	Meyer, Anna	604	Reichard, E.	718
Kammer, Henry	631	" , Fredr.	574	Reimer, Friedr.	488
Kane, Nora	501	" , George	532	Rekha(?), Matthew	698
Kiddle, James	645	" , Michael	606	Reminger, Ths.	739
Kinderwatter, Fritz	684	" , Ulrich	564	Reth, Ernst	614
" , Fredr.	560	" , William	700	Rexford, Stephen	483
Klochmetts, Thos	651	Miller, John	483	Ribbert, John	703
Klotz, Adam	744	" "	703	Richards, Samuel	654
" , Fredka.	514	" , John A.	601	Riddel, James	518
Knauf, Henry	478	Minard, Frank	730	Riebling, John H.	683
Knissch, Bernhard	541	" , Henry	730	Riegel, Samuel	550
" , John	520	Mineman, Henry	578	Roberts, Louisa	731
" , Mary	521	Mohr, John	618	Roche, John	480
Koth, Charles	745	" "	648	Roeder, John	542
Kott(?), Charles	485	Moss, Thos.	729	Roemer, Christ.	593
Krahn, Carl	507	Mueller, Chas.	504		
		" , Frank	656		
		" , Fredr.	523		

Roesner, Lorenz	554	Schulz, William	653	Taris(?), Charles	694
Rorhrohr(?), Samuel	557	Schulze, August	577	Tool, Charles	668
Roser, John	610	" , Christoph	575	Toz(?), Franklin	704
Rosner, Fred	547	" , John	524	Trentz, Fredr.	553
Ruediger, Ferd.	672	" , "	579		
Ruediger, J.T.	672	" , Peter	555	Uhland, Fredr.	522
Ruf, Andrew	562	" , William	509	Uhlman, Ludwig	529
" , Jacob	628	Schwartz, Charles	617		
Rumoser, Frd.	608	Schwartz, Franz	620	Van Berg, Frdr.	685
Ryen, Edward	483	" , William	524	Vill(?), William	725
		Shepherd, C. D.	636	Vogt, C. F.	675
Sailor, Frank	721	" , F. G.	637	" , Peter	510
Sathleben(?), Auguste	474	" , W. E.	638	Von Renner, Waldemar	572
Scameron, John	731	Shueman, Henry	486	Vos(r?)kaeuffer, Louis	507
Schahal, Louisa	527	Sippel, Geo.	641	" , Mich'l	508
Schallen, Lorenz	741	" , "	662		
Schaumburg, John	513	" , Henry	360	Wagemma, Martin	726
Schill, George	680	" , "	728	Wagenrad, Wm.	730
" , Jacob	679	" , Jacob	661	Wagner, George	607
Schilling, David	735	" , John	663	Walter, William	498
" , George	576	" , Wm.	589	Warnow, Christian	587
" , "	724	Slade, Ludwig	692	Wathams, Ruay	552
Schimmel, I. M.	650	Smith, Betsy	699	Weber, George	592
Schmal, Charles	626	" , Patrick	656	" , "	633
Schmahl, Chs.	737	Soeholz, Henry	522	" , Paul	632
Schmidt, Adolph	564	Specht(?), Peter	693	Weise, Gottlieb	709
" , August	476	Spink, William	602	Wenman, Frd.	622
" , Christoph	570	Stahl(Stohl?), Chas.	616	Wetzel, Mina	672
" , Ferd.	610	Stelter, Fritz	579	Whit, David	483
" , Mary	565	" , Henry	578, 579	White, Jane	598
Schmitt, Henry	683	Stephens, Fredr.	552	Wilhelm, George	682
Schuedler, John	621	" , Jacob	596	Wilke, Fredr.	623
Schneider, Math.	629	Stockmann, Fredr.	573	Wills, Henry	665
Schrier, Martin	629	Stockle, Henry	517	Wilson, Elisa	519
Schroeder, Bertha	615	Stoehr(?), Christoph.	594	Wiste, William	611
" , Christoph	574	Strohmann, Peter	558	Witte(?), Christian	615
" , Frederick	653	Stumph(?), Michael	494		
" , John	653	Sturz, John	708	Young, Elisa	601
Schuesoler, Gg. M.	555	Sullivan, Mariane	484		
Schmahl, Chs.	737			Zacharias, Frdr.	505
Schulz, Henry	646	Tanley, Samuel	644		

\* \* \* \* \*  
CCUTAYSHUN--CENSUS TAKER Western New York Genealogical Society Journal  
 Vol. III; 1, June 1976, p. 13

"I am a census taker for the City of Buffalo. Our city has groan very fast in recent years and now, in 1865, it has becum a hard and time consuming job to count all of the peophill. There are not many that can do this werk, as it is nesecarie to have an ejucaashun, wich a lot of pursons still do not have. Another atribeart needed for this job is good speling, for meny of the pepill to be counted can hardly speek English, let alon spel there names!"

We quote the first paragraph. Read the whole article for a good laugh and also for insight on some of the problems we have in reading old census records.  
 Contributed by Ira E. Bishop

THE GOTHIC ALPHABET

Up until about World War II German was mostly printed in Gothic type, called FRAKTUR. Today, this type is no longer in common use. However, if you are thinking of visiting a cemetery used by people of German ancestry or using their Bible records you may want to have this alphabet at hand.

ROMAN		FRAKTUR		ROMAN		FRAKTUR	
A	a	Ⓐ	ⓐ	N	n	Ⓝ	Ⓝ
B	b	Ⓑ	ⓑ	O	o	Ⓞ	Ⓞ
C	c	Ⓒ	ⓒ	P	p	Ⓟ	Ⓟ
D	d	Ⓓ	ⓓ	Q	q	Ⓠ	Ⓠ
E	e	Ⓔ	ⓔ	R	r	Ⓡ	Ⓡ
F	f	Ⓕ	ⓕ	S	s	Ⓢ	Ⓢ
G	g	Ⓖ	ⓖ	T	t	Ⓣ	Ⓣ
H	h	Ⓗ	ⓗ	U	u	Ⓤ	Ⓤ
I	i	Ⓘ	ⓓ	V	v	Ⓥ	Ⓥ
J	j	Ⓝ	ⓓ	W	w	Ⓦ	Ⓦ
K	k	Ⓚ	ⓕ	X	x	Ⓧ	Ⓧ
L	l	Ⓛ	ⓕ	Y	y	Ⓨ	Ⓨ
M	m	Ⓜ	ⓓ	Z	z	Ⓩ	Ⓩ

*Lateinische  
Ausgangsschrift*

*Dänische Schrift*

a b c d e f g h i j	ⓐ ⓑ ⓒ ⓓ ⓔ ⓕ ⓖ ⓗ ⓘ ⓙ
k l m n o p q r s	Ⓚ Ⓛ Ⓜ Ⓨ Ⓞ Ⓟ Ⓠ Ⓡ Ⓢ
ß (fs) t u v w x y z	Ⓣ Ⓤ Ⓥ Ⓦ Ⓧ Ⓨ Ⓩ
ä ö ü (.,.,. = !?)	ⓐ ⓑ Ⓝ Ⓞ Ⓟ Ⓠ Ⓡ Ⓢ Ⓣ Ⓤ Ⓥ Ⓦ Ⓧ Ⓨ Ⓩ
A B C D E F G H I J	Ⓐ Ⓑ Ⓒ Ⓓ Ⓔ Ⓕ Ⓖ Ⓗ Ⓘ Ⓝ
K L M N O P Q R	Ⓚ Ⓛ Ⓜ Ⓨ Ⓞ Ⓟ Ⓠ Ⓡ Ⓢ
S T U V W X Y Z	Ⓣ Ⓤ Ⓥ Ⓦ Ⓧ Ⓨ Ⓩ
Ä Ö Ü	ⓐ ⓑ Ⓝ Ⓞ Ⓟ Ⓠ Ⓡ Ⓢ Ⓣ Ⓤ Ⓥ Ⓦ Ⓧ Ⓨ Ⓩ